

## Indoor video intercom station VTC60

---



### Ring-tones

Ring-tones sound different by calls from the entrance, the landing door or for an internal call. The green LED lights up for 1 minute when there is a call by one of these sources. The image is automatically displayed when there is a call at the door.

## Overview of the device

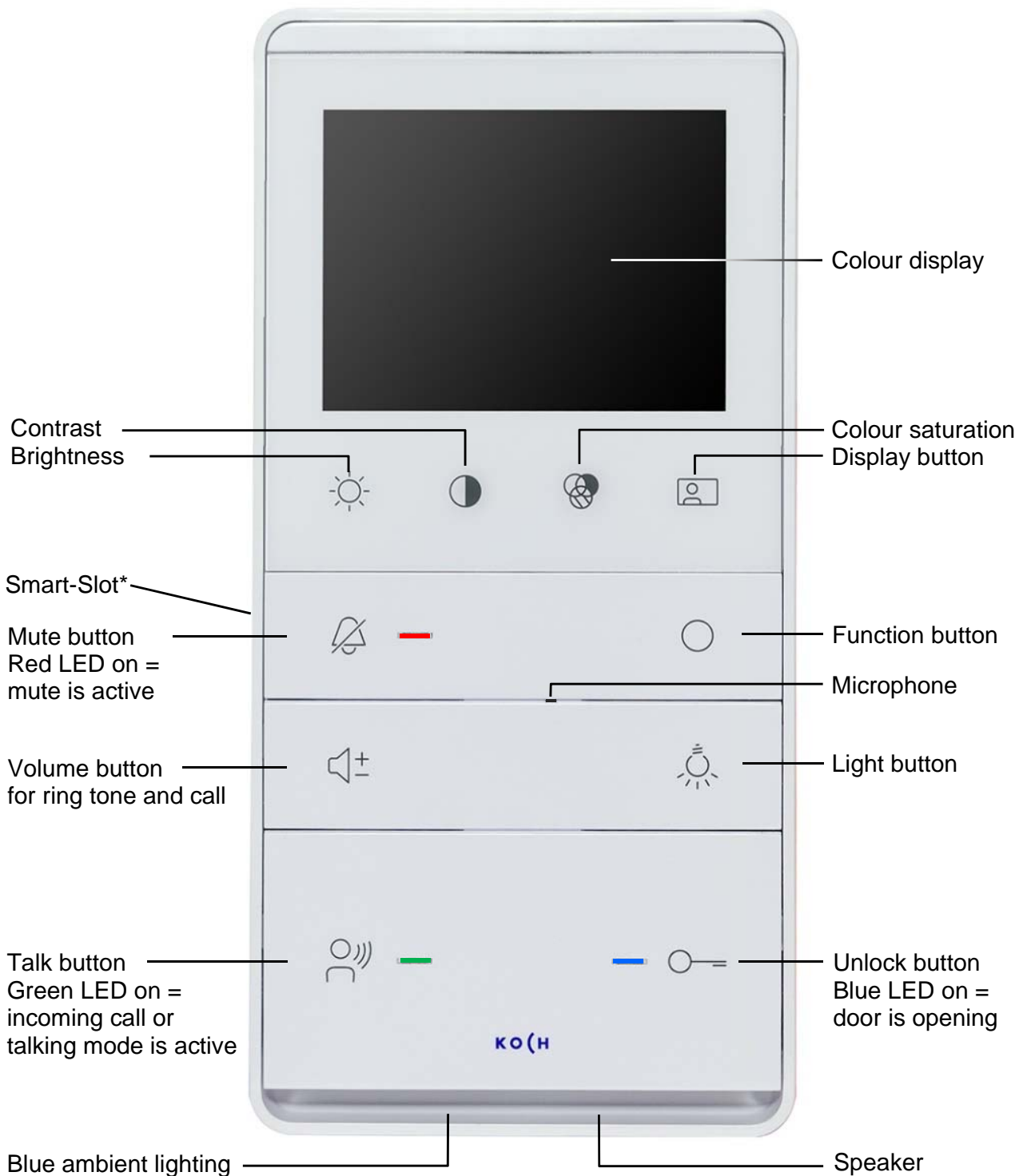

\*Smart-Slot = additional radio transmitter for a remote radio gong

## Instructions for use

- |                                       |  |
|---------------------------------------|--|
| Answer a call                         | <ul style="list-style-type: none"><li>• Press the <i>talk button</i> briefly; you now can talk without the need for any further action (hands-free)</li><li>• If the talk button is pressed for more than 1 sec. the unit switches to <i>Press-to-talk</i> mode (useful when surrounding noise is disturbing): press talk button &gt; talk / release talk button &gt; listen</li></ul> |
| End a call                            | <ul style="list-style-type: none"><li>• Press the <i>talk button</i> briefly. Talk mode also turns off automatically after 60 sec. or 4 sec. after the <i>unlock button</i> has been pressed.</li></ul>  |
| Unlock the door                       | <ul style="list-style-type: none"><li>• Briefly press the <i>unlock button</i></li></ul>   |
| Turn on/off the door call             | <ul style="list-style-type: none"><li>• Press the <i>mute button</i> briefly: red LED on = door call off</li></ul>   |
| Display image                         | <ul style="list-style-type: none"><li>• Manually: Press the <i>Display button</i> briefly<br/>Display switches on automatically with call at door</li></ul>  |
| Switch off monitor display            | <ul style="list-style-type: none"><li>• Display shuts down automatically after 80 sec. or 4 sec. after pressing the <i>Unlock button</i> (during talking mode)</li></ul>   |
| Turn on the light                     | <ul style="list-style-type: none"><li>• Press the <i>light button</i></li></ul>  |
| Control function 8<br>(Setup default) | <ul style="list-style-type: none"><li>• Press the <i>function button</i></li></ul>   |

# Settings

## Programming the ring tones

### 1.) Switch on programming mode

- Press the *mute button* for approx. 8 sec until you hear a brief beep
- all the LEDs will light up

### 2.) Select ring tone

- Select the ring tone by pressing the corresponding *Ring Tone Control button* (see below) until you hear the one you require (the unit stores the last ring tone to be selected)

Ring Tone Control buttons:

*Unlock button*

*Talk button*

*Light button*

*Function button*

- Ring tone setting for the entrance door 1 (AS 0)
- Ring tone setting for the entrance door 2 (AS 1-63)
- Ring tone setting for the landing door
- Ring tone setting for an internal call

Note

- The ring-tones can be set in succession once the programming mode has been activated

### 3.) End programming mode

- The programming mode switches off automatically after 8 seconds of no activity
- A beep sounds; the LEDs go out

## Setting the volume

Call volume

- during a call, press the *volume button* repeatedly to select the required volume for talking (default: level 3 of 4)

Ring tone volume

- in idle mode, press the *volume button* repeatedly to select the required volume for ring tone (default: level 3 of 4)

**Blue ambient light**

- press the *light button* for 4 seconds to activate/deactivate

**Additional functions**

*to be programmed by your electrician, e.g.:*

- *parallel operation of several indoor intercom station*
- *blocking the ring tone selection*
- *internal conversation, call forwarding, door opener, etc.*

## Care

Clean the intercom unit with a dry or slightly damp cloth.  
Use a household detergent to remove more stubborn stains.

- **Prevent any water from entering the unit!**
- **Do not use any sharp or abrasive cleaning agents!**